



Moto Guzzi Alce 500 HDM35120

HD Models
Via Filippo Nicolai, 24
00136 - Roma

+39 06 39736835
infohdmodels.it
www.hdmodels.it

1/35

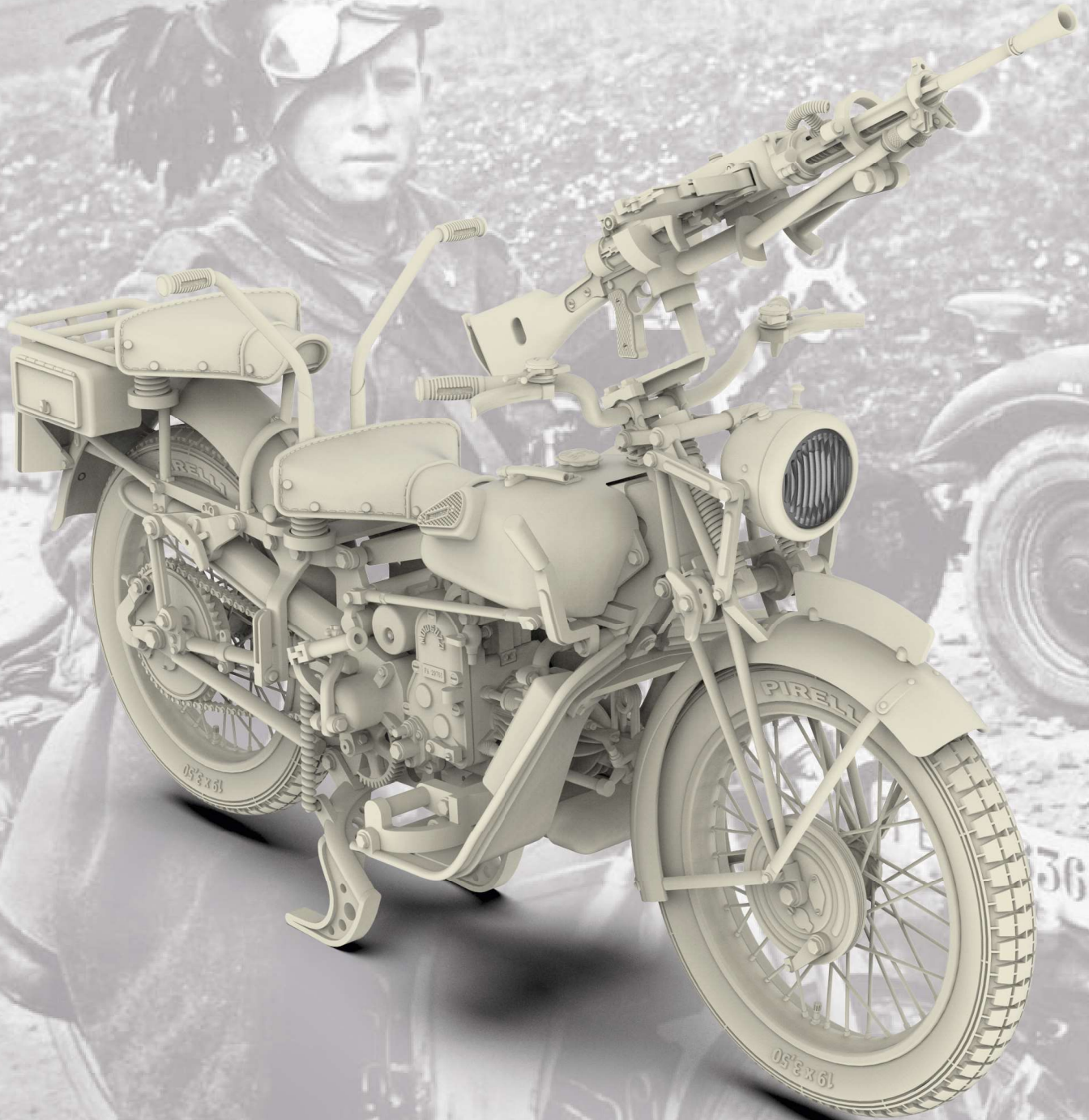

Moto Guzzi Alce 500

HDM35120



L'Alce nacque nel 1939 per sostituire la Moto Guzzi GT 20, a sua volta derivata nel 1938 dalla Moto Guzzi GT 17, in produzione invece dal 1932 al 1939. Rimase in produzione fino al 1945. Tra il 1946 e il 1948 venne prodotta in un numero imprecisato di esemplari anche la versione di transizione Alce V con caratteristiche ibride tra i due modelli (passaggio alle valvole in testa) e successivamente la versione Superalce. Il numero motore è caratterizzato in una prima fase dal prefisso AV (Alce Veloce) ed in una seconda fase dal prefisso SA (Superalce).

I numeri di telaio fino al 1954 seguono la progressione numerica di tutti i monocilindrici 500, e successivamente iniziano con la numerazione S 00 AA fino al numero S 79 AR del 1958. Acquisita anche dalla Milizia della Strada e dalla Polizia dell'Africa Italiana, fu estesamente impiegata dal Regio Esercito durante la seconda guerra mondiale su tutti i fronti in tutte le tre versioni Monoposto, Biposto ed Attrezzata (ovvero la versione motocarrozzetta), con un totale di 6390 esemplari tra mono e biposto e 669 esemplari sidecar. Tra il 1940 ed il 1943 dalla meccanica dell'Alce fu sviluppato un motocarro militare, il TriAlce, prodotto in 1741 esemplari.

Nel Regio Esercito venne assegnata a tutti i reggimenti come mezzo da esplorazione e guida-colonna; tra gli altri, equipaggiava interi reggimenti bersaglieri motociclisti. Un particolare allestimento era quello porta-arma, con un fucile mitragliatore Breda Mod. 30 installato su supporto brandeggiabile sul perno della forcella anteriore. L'arma non poteva essere usata in movimento ma la moto fungeva da supporto per il fuoco da fermo.

Dopo la guerra, rimase in servizio sia con l'Esercito Italiano che con la Polizia Stradale, per essere sostituito nel 1948 dal Moto Guzzi Superalce (Wikipedia).

HD Models ha progettato questo modello completamente da zero, basandosi su disegni originali e da foto di alcuni esemplari presenti nei musei. Il kit è stampato in resina con stampanti 3D ad alta risoluzione, che hanno permesso di riprodurla fin nei più piccoli dettagli. La versione proposta è quella con doppia sella e Breda Mod. 30 montata sul cannotto dello sterzo tramite una staffa, che ne permetteva il brandeggio quando la moto era ferma.

Parts List

HDM35120



1

Breda 30 1_35.stl



2

Breda blocco staffa inferiore 1_35.stl



3

Breda blocco staffa superiore 1_35.stl

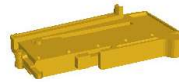

4

Breda caricatore 1_35.stl



5

Breda cavalletto dx 1_35.stl



6

Breda cavalletto sx 1_35.stl



7

Breda staffa principale 1_35.stl



8

carburatore 1_35.stl



9

carter e volano 1_35.stl

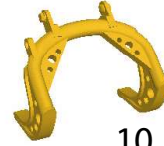

10

cavalletto 1_35.stl



11

clacson 1_35.stl



12

corona e catena 1_35.stl



13

faro anteriore 1_35.stl



14

forcella anteriore 1_35.stl



15

forcella post dx 1_35.stl



16

freno anteriore 1_35.stl



17

leva cambio e asta 1_35.stl



18

leva messa in moto 1_35.stl



19

manubrio 1_35.stl



20

manubrio passeggero 1_35.stl



21

marmitta 1_35.stl



22

molla cavalletto aperto 1_35.stl



23

molla cavalletto chiuso 1_35.stl



24

paracatena 1_35.stl



25

pedale freno 1_35.stl



26

pedana dx aperta passeggero 1_35.stl



27

pedana dx chiusa passeggero 1_35.stl



28

pedana sx aperta passeggero 1_35.stl



29

pedana sx chiusa passeggero 1_35.stl



30

perno freno posteriore 1_35.stl

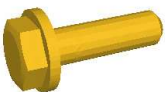

31

perno mozzo posteriore 01 1_35.stl



32

portapacchi sella doppia 1_35.stl



33

portatarga 1_35.stl

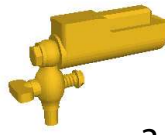

34

rubinetto olio 1_35.stl



35

ruota anteriore 1_35.stl



36

ruota posteriore 0_045 1_35.stl



37

scudi frontali 1_35.stl



38

sella anteriore 1_35.stl



39

sella posteriore 1_35.stl



40

serbatoio 1_35.stl

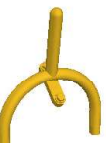

41

struttura anteriore sella posteriore 1_35.stl



42

struttura posteriore sella posteriore 1_35.stl



43

Telaio e corpo motore 1_35.stl



44

testata motore 1_35.stl



45

vetro fanale posteriore 1_35.stl



46

vetro faro anteriore 1_35.stl



HDMODELS

Kit Assembly
HDM35120

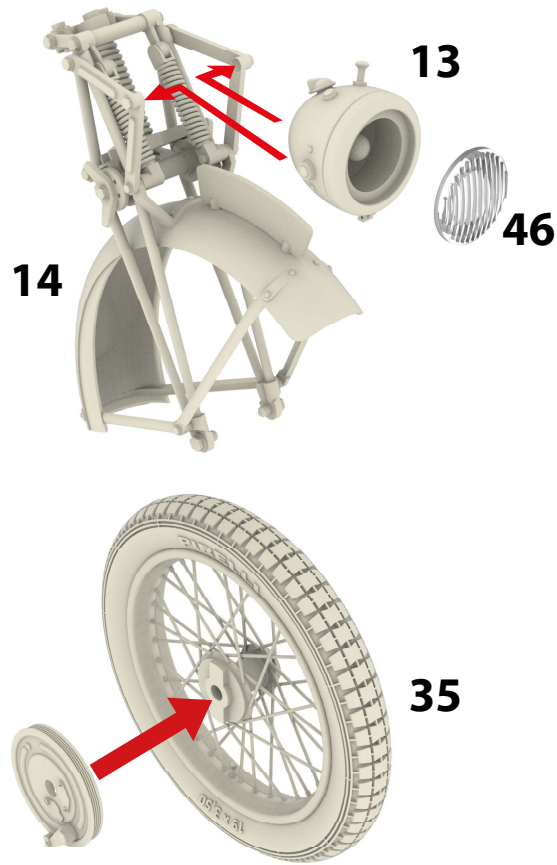

STEP 1

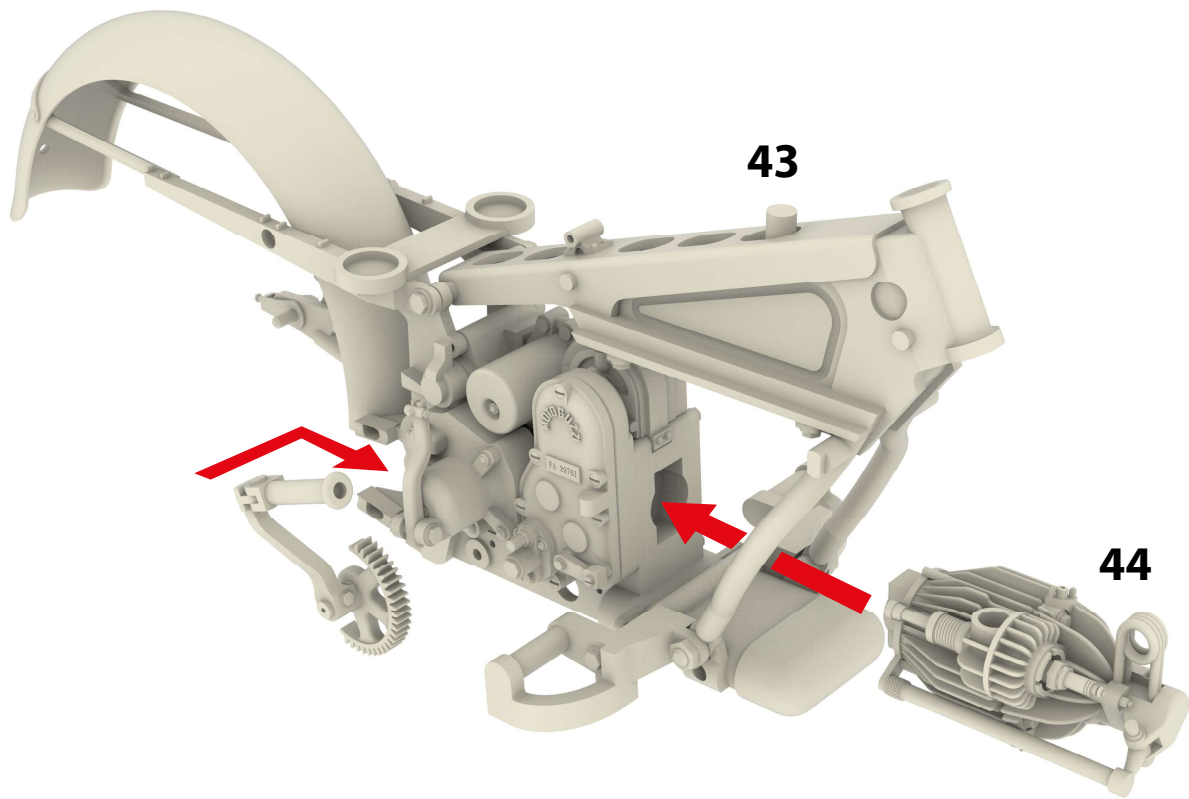

STEP 2

Kit Assembly
HDM35120

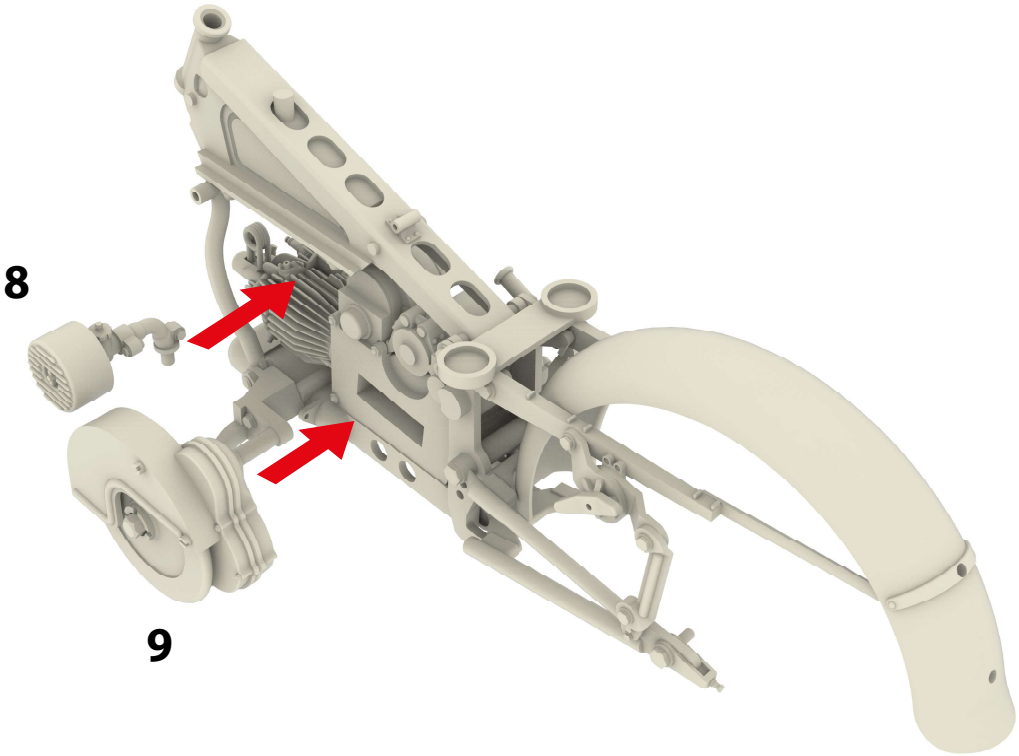

STEP 3

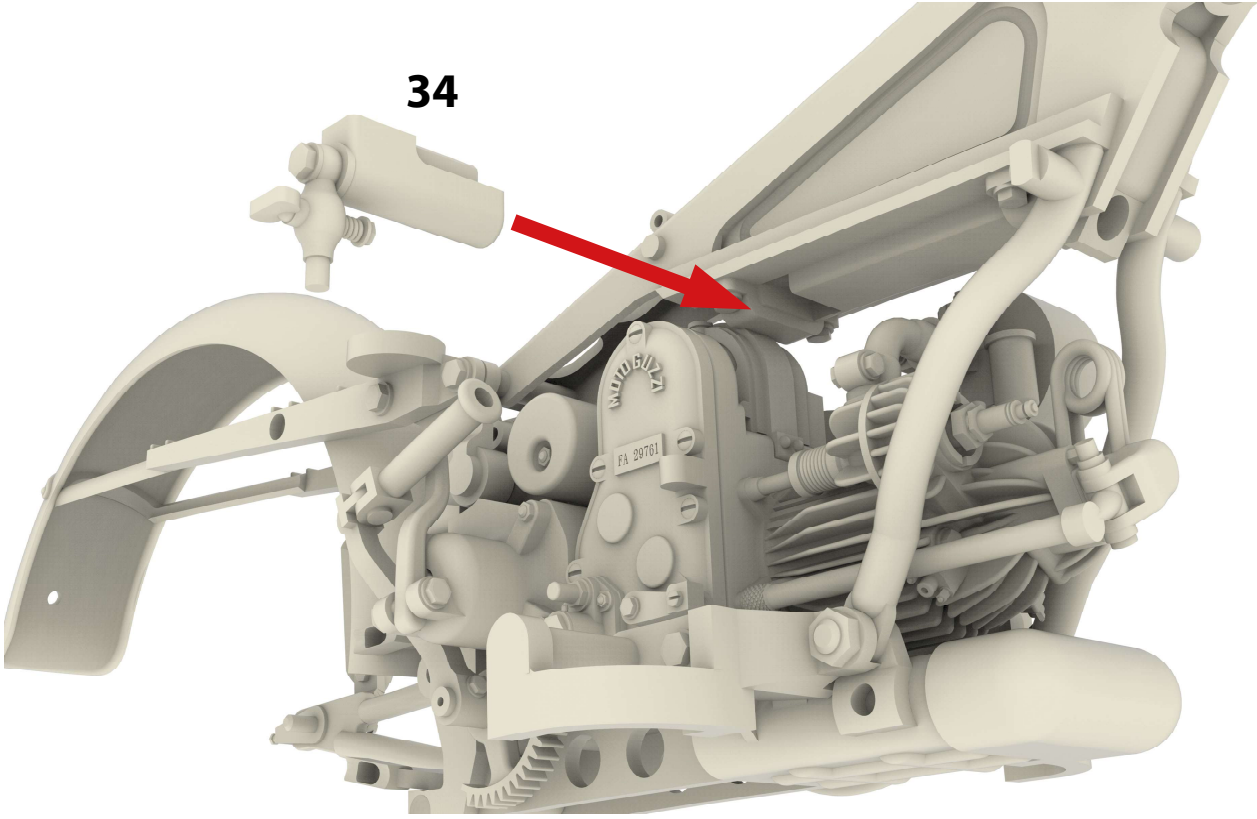

STEP 4

Kit Assembly
HDM35120

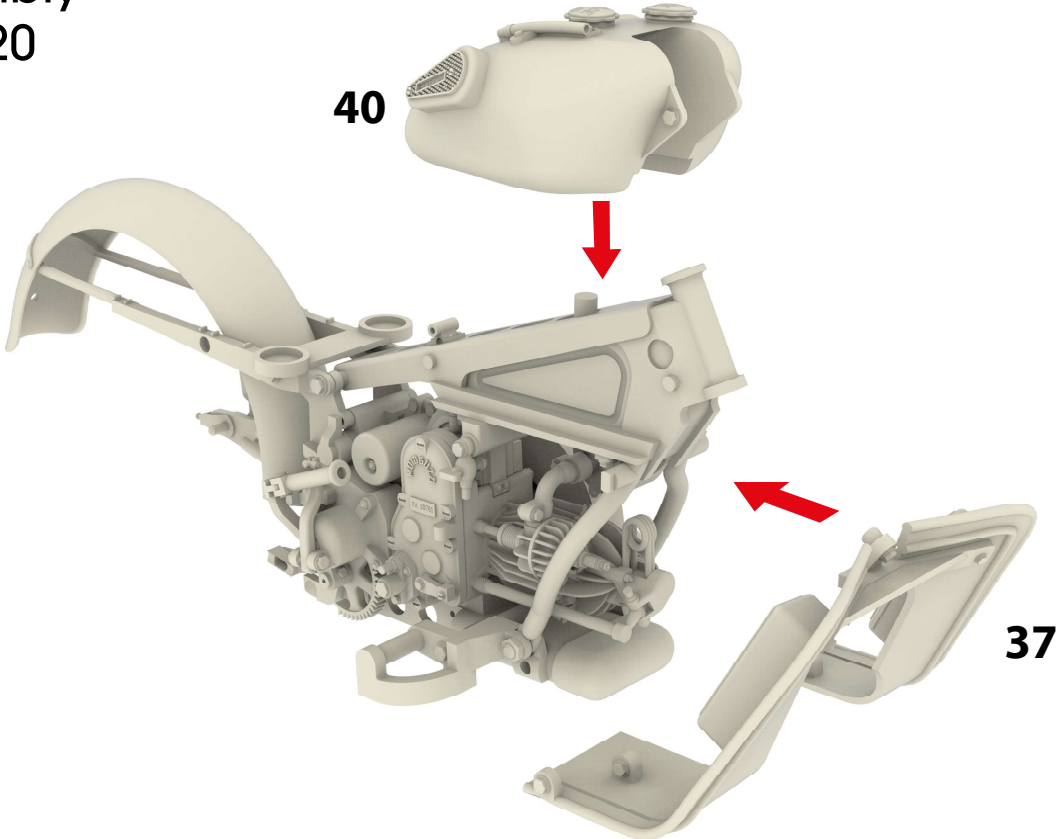

STEP 5

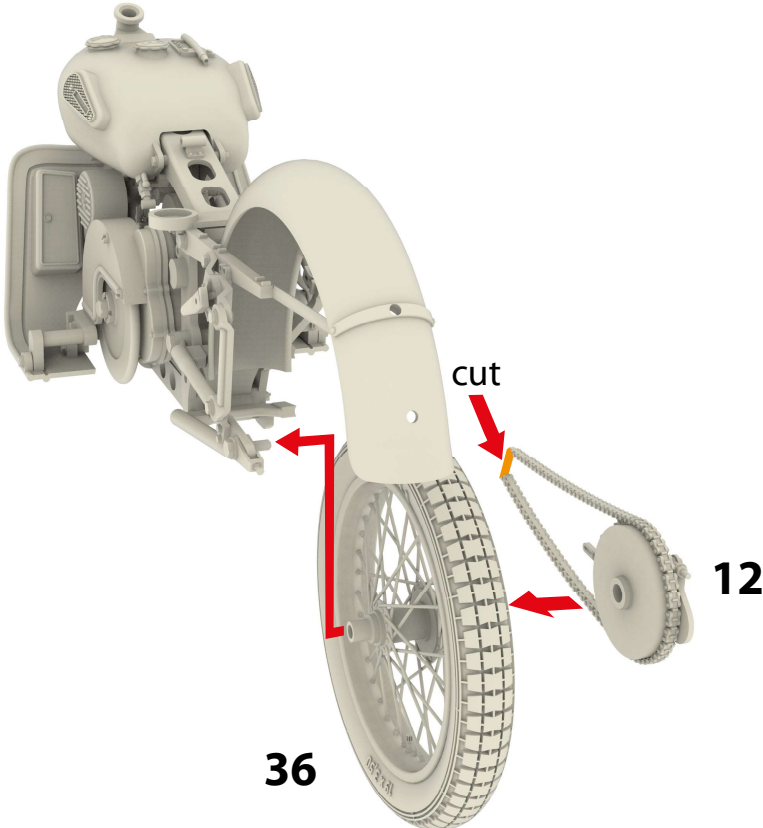

STEP 6

Kit Assembly
HDM35120

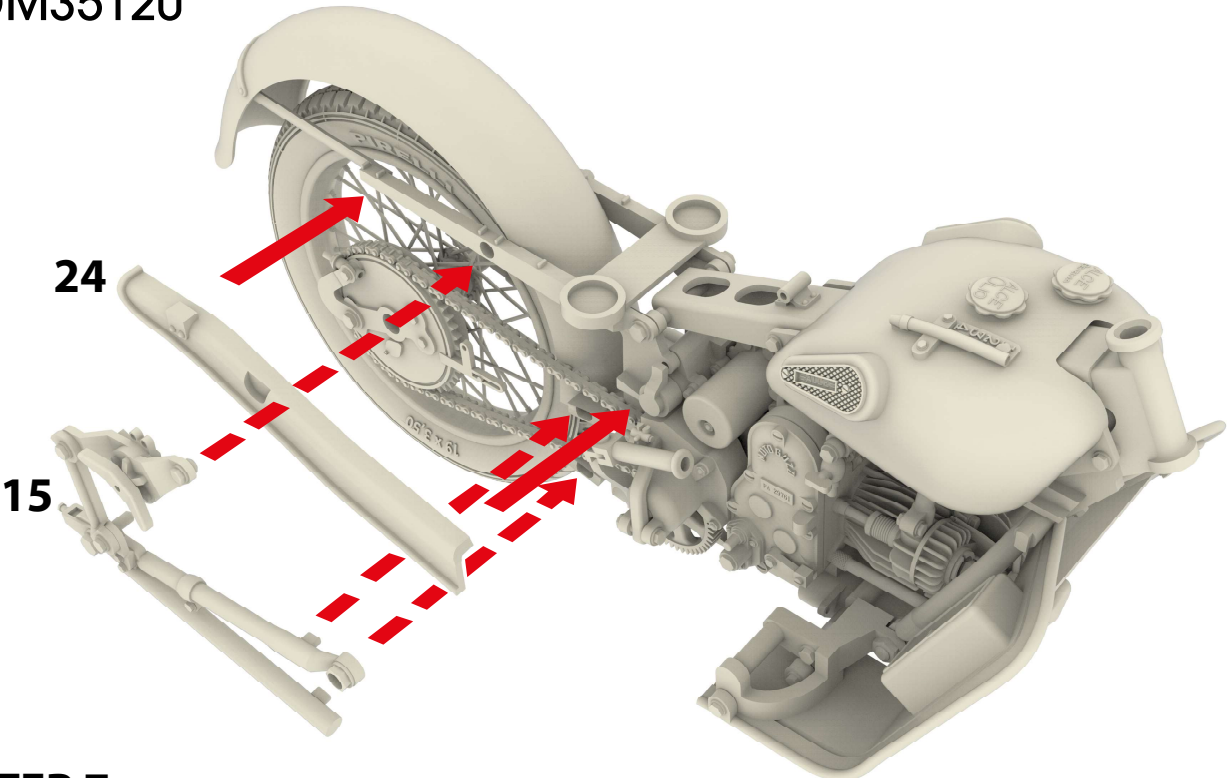

STEP 7

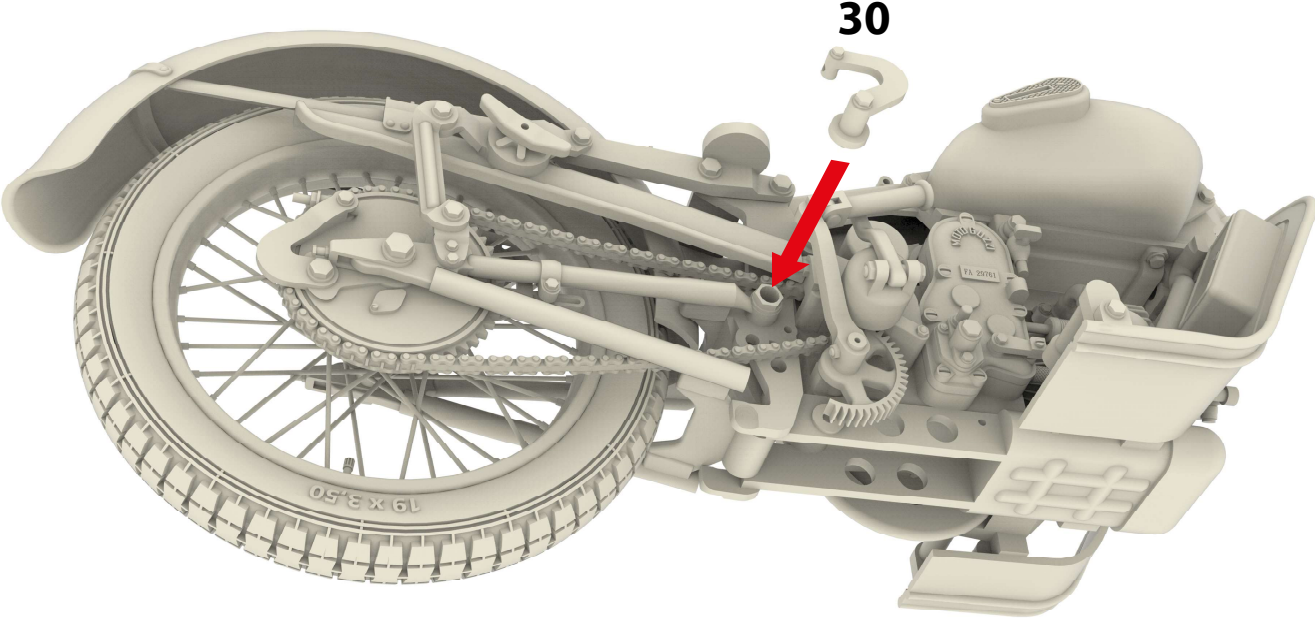

STEP 8

Kit Assembly
HDM35120

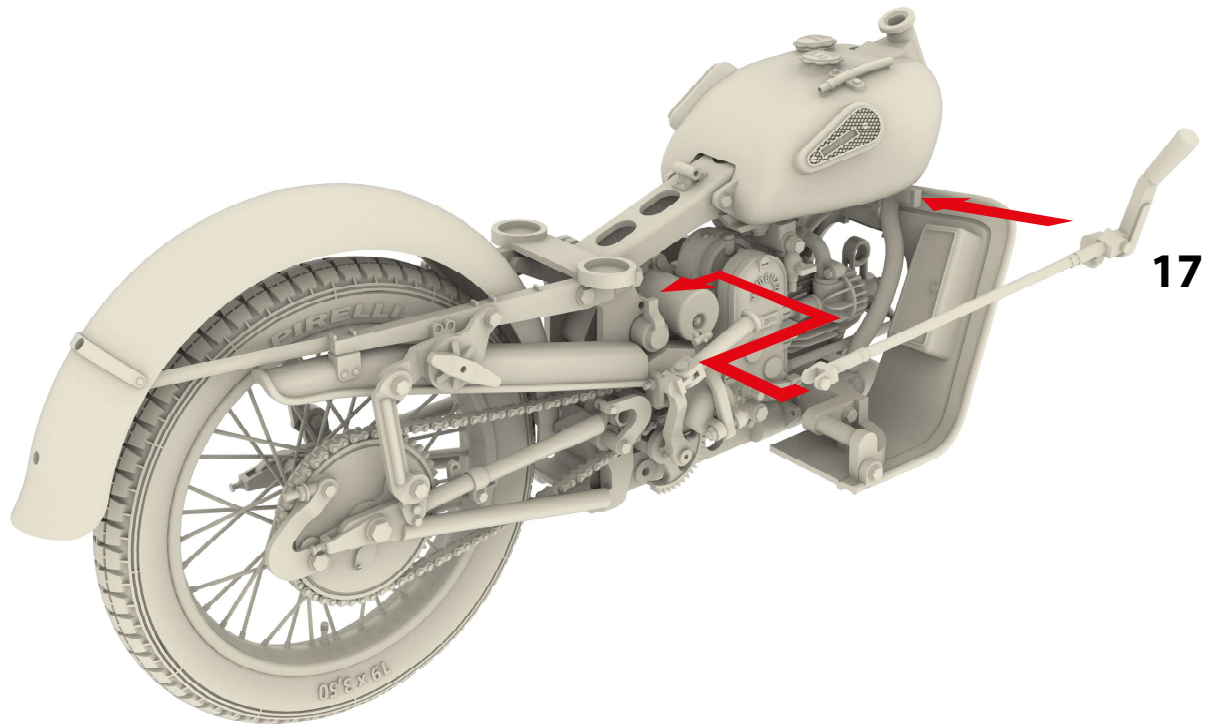

STEP 9

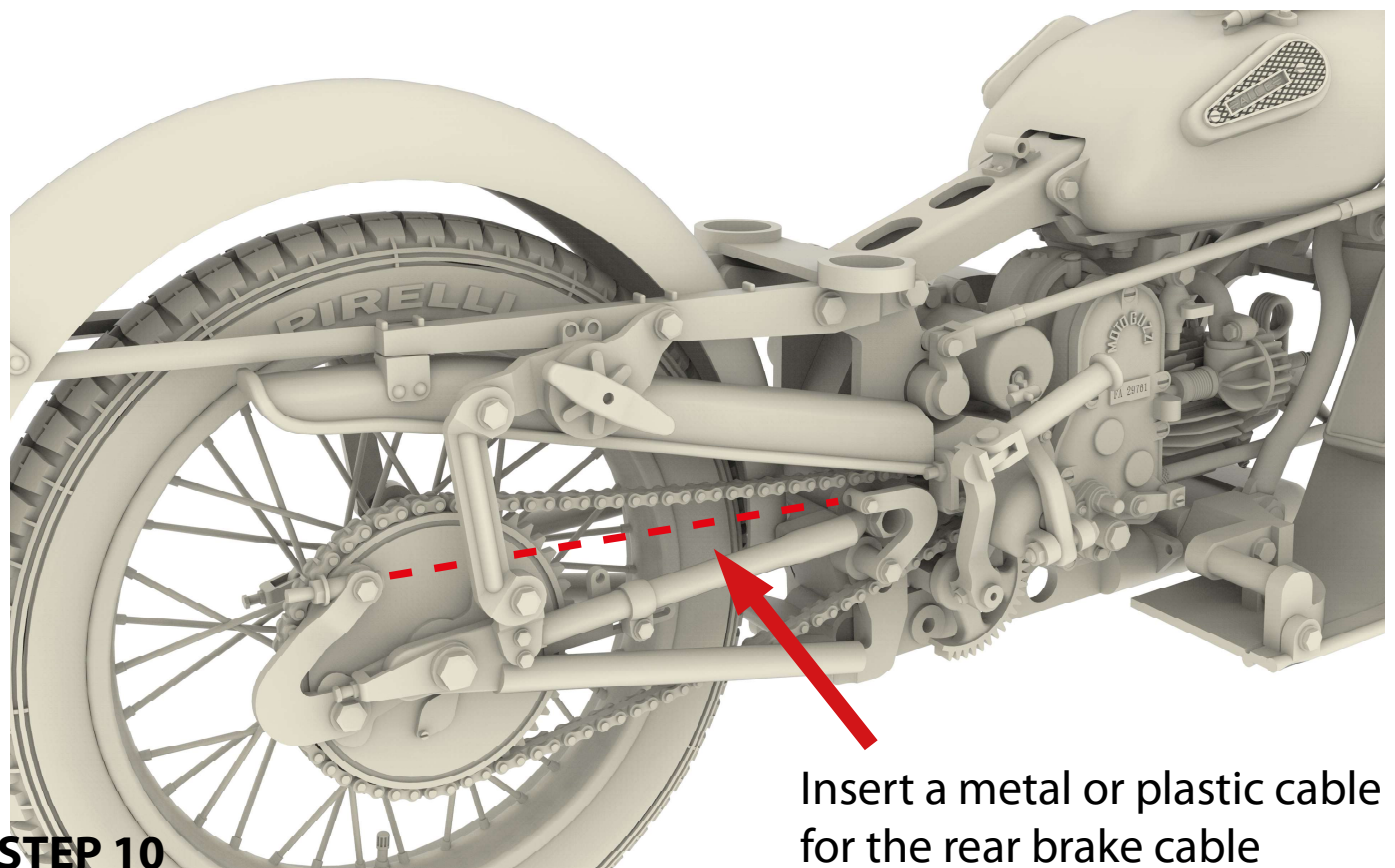

STEP 10

Insert a metal or plastic cable
for the rear brake cable

Kit Assembly
HDM35120

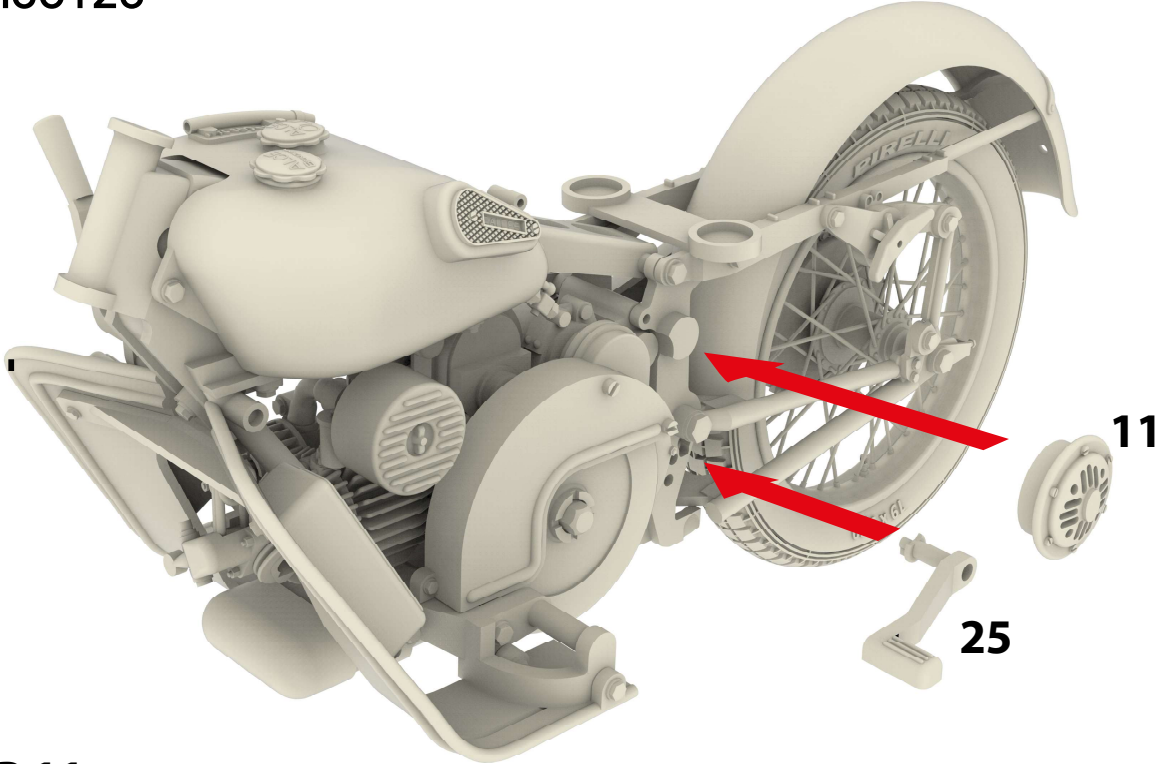

STEP 11

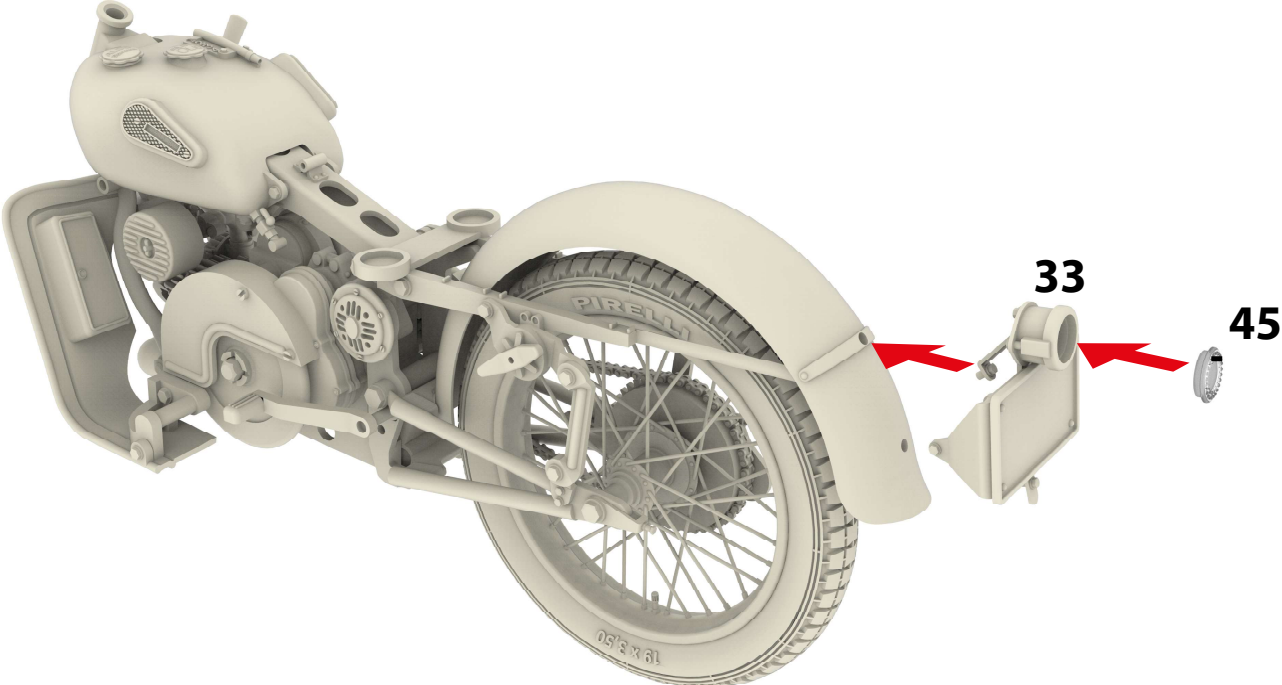

STEP 12

Kit Assembly
HDM35120

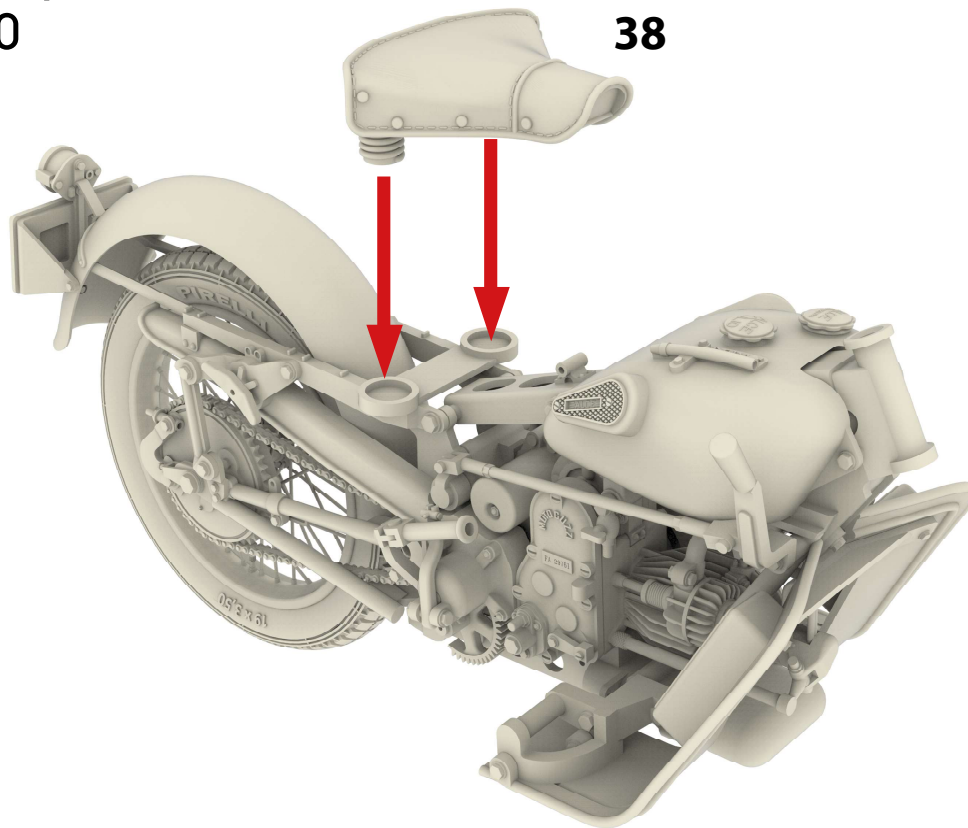

STEP 13

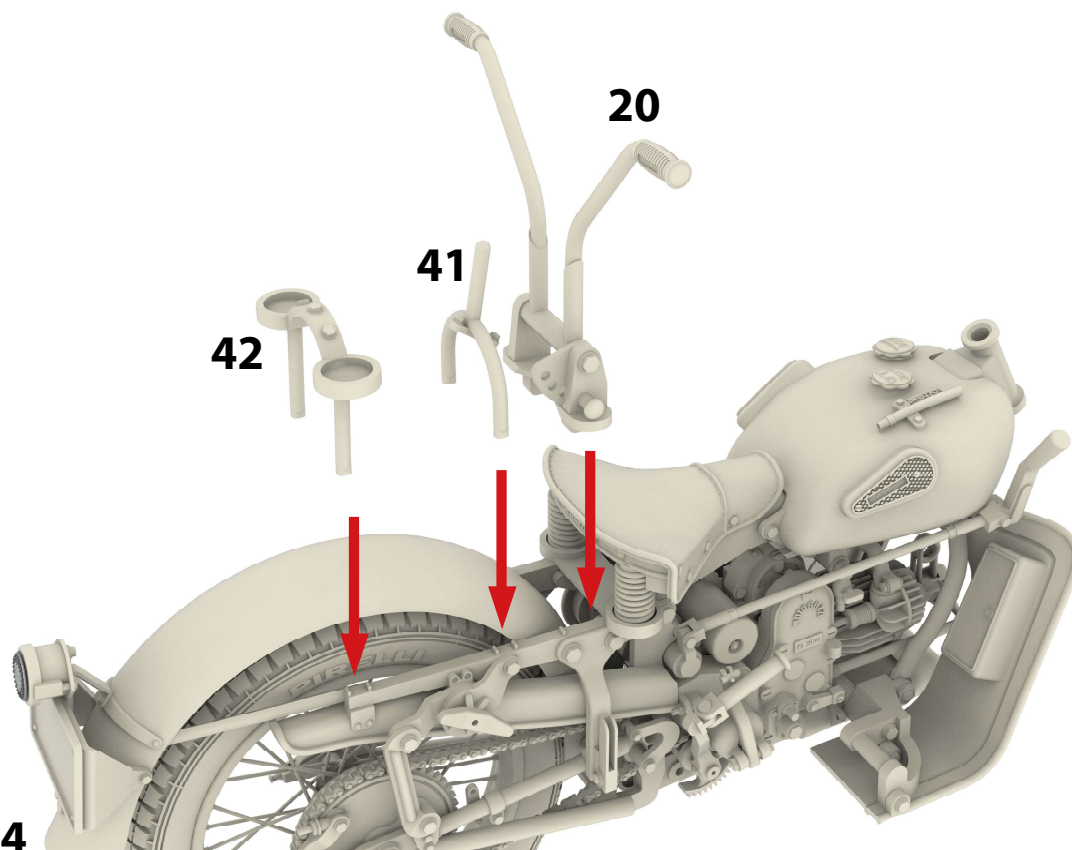

STEP 14

Kit Assembly
HDM35120

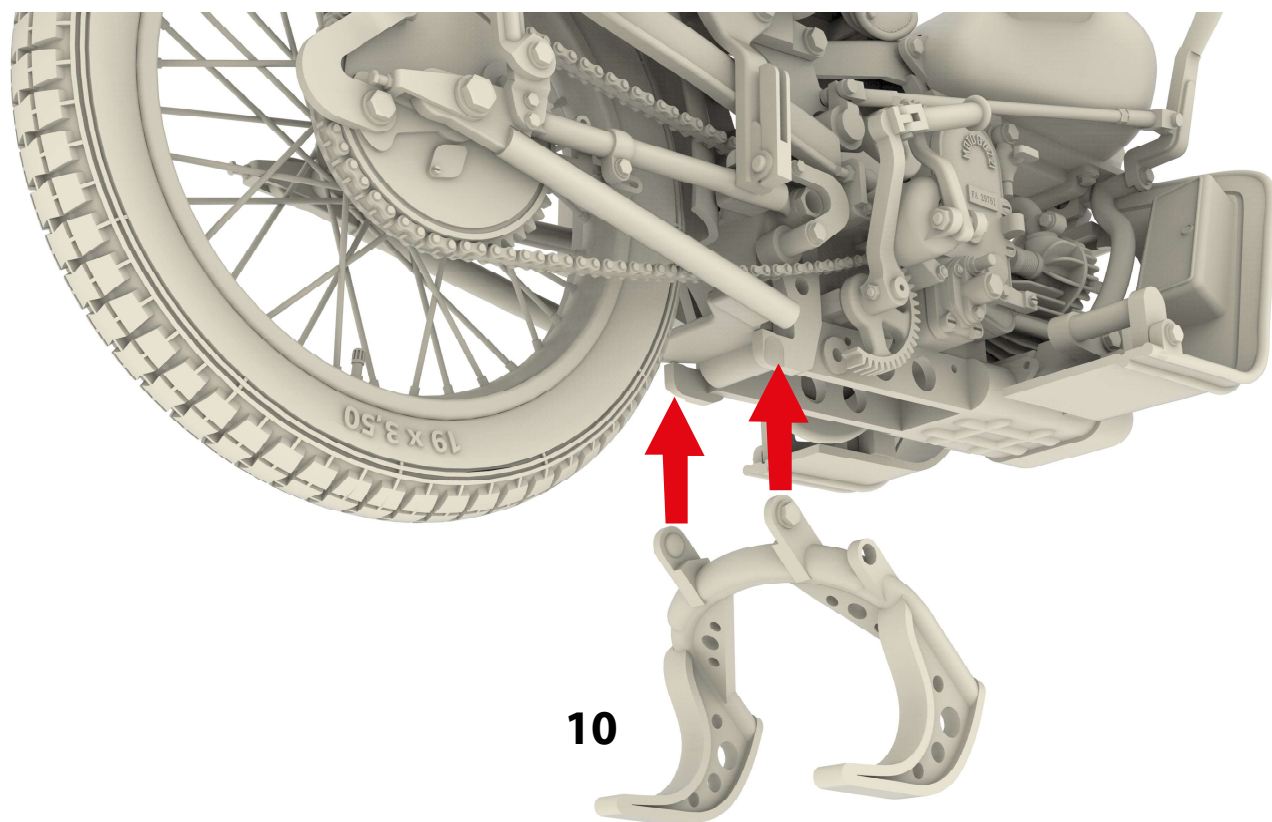
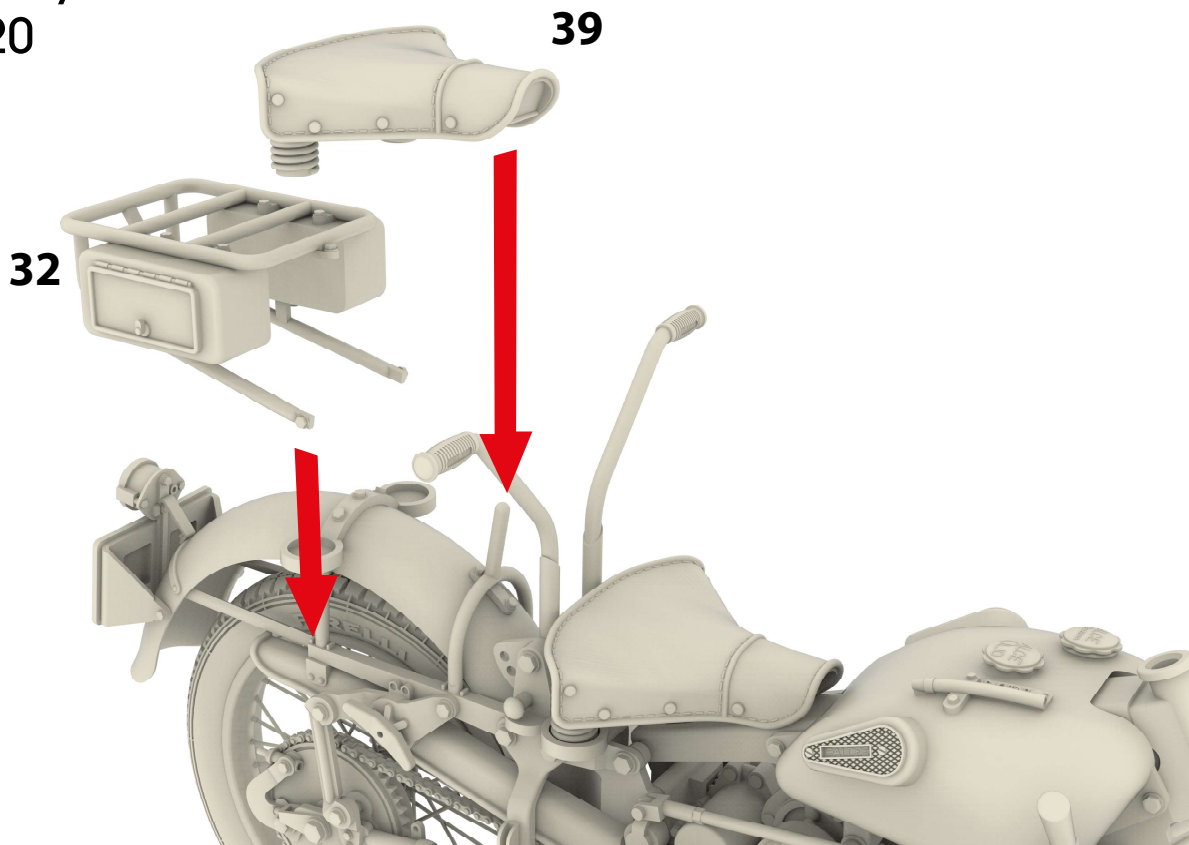

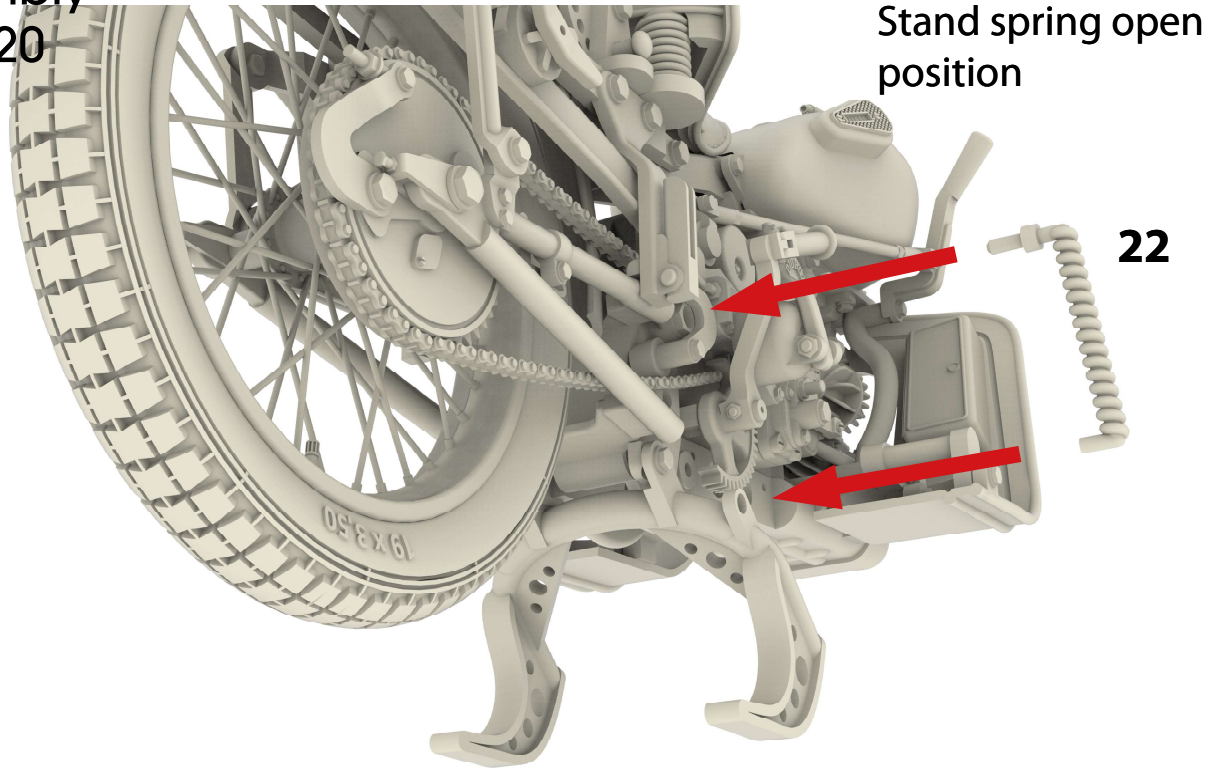

STEP 17

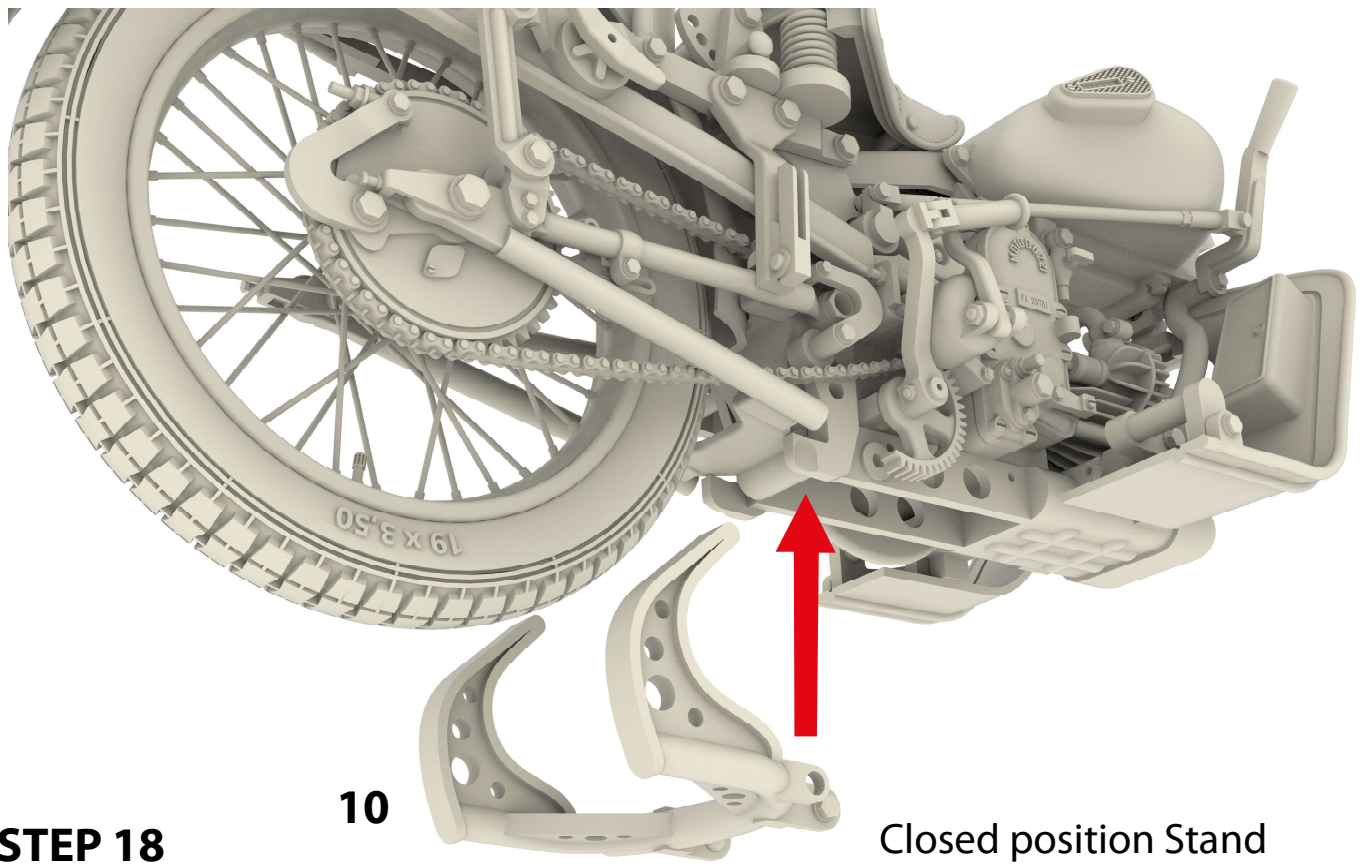

STEP 18

Stand spring
closed position

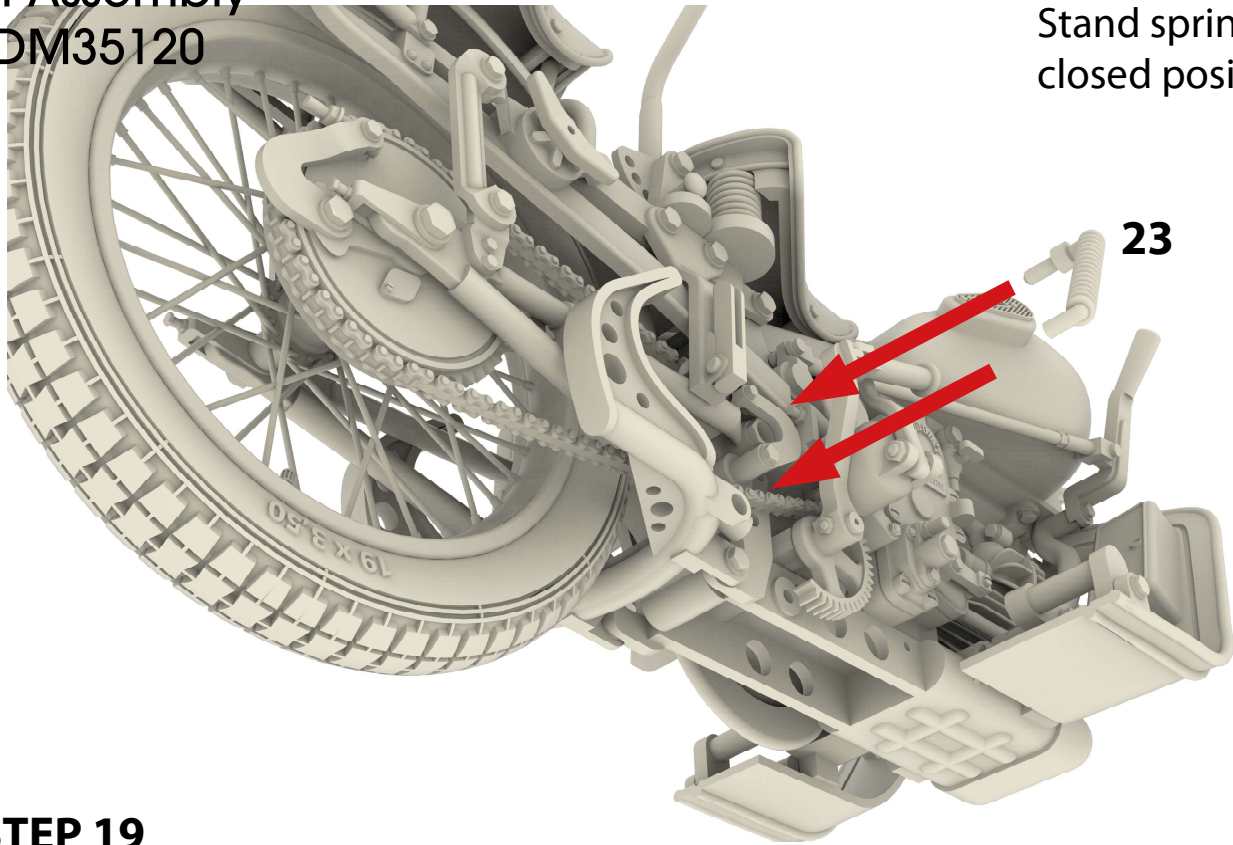

STEP 19

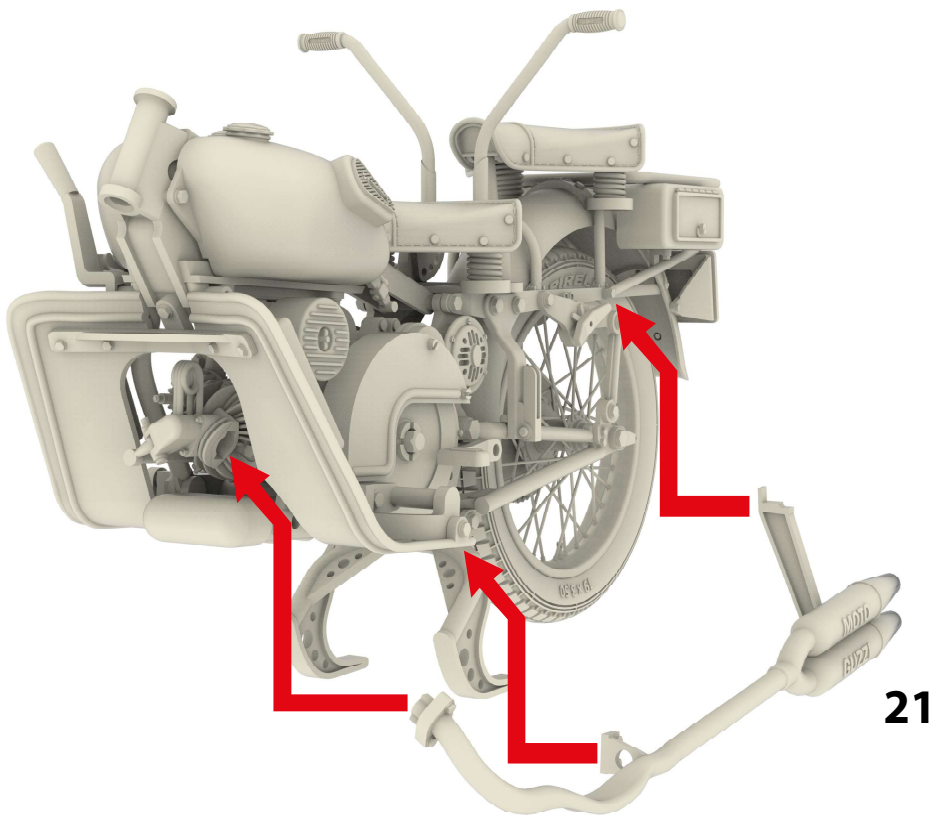

STEP 20

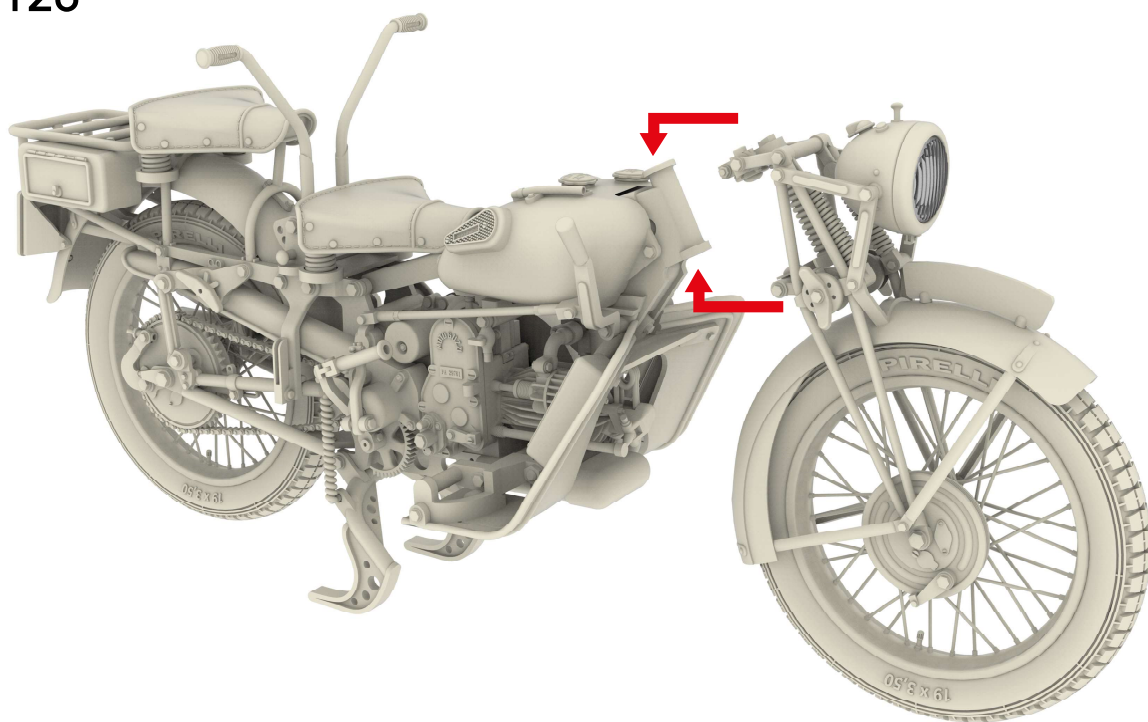

STEP 21

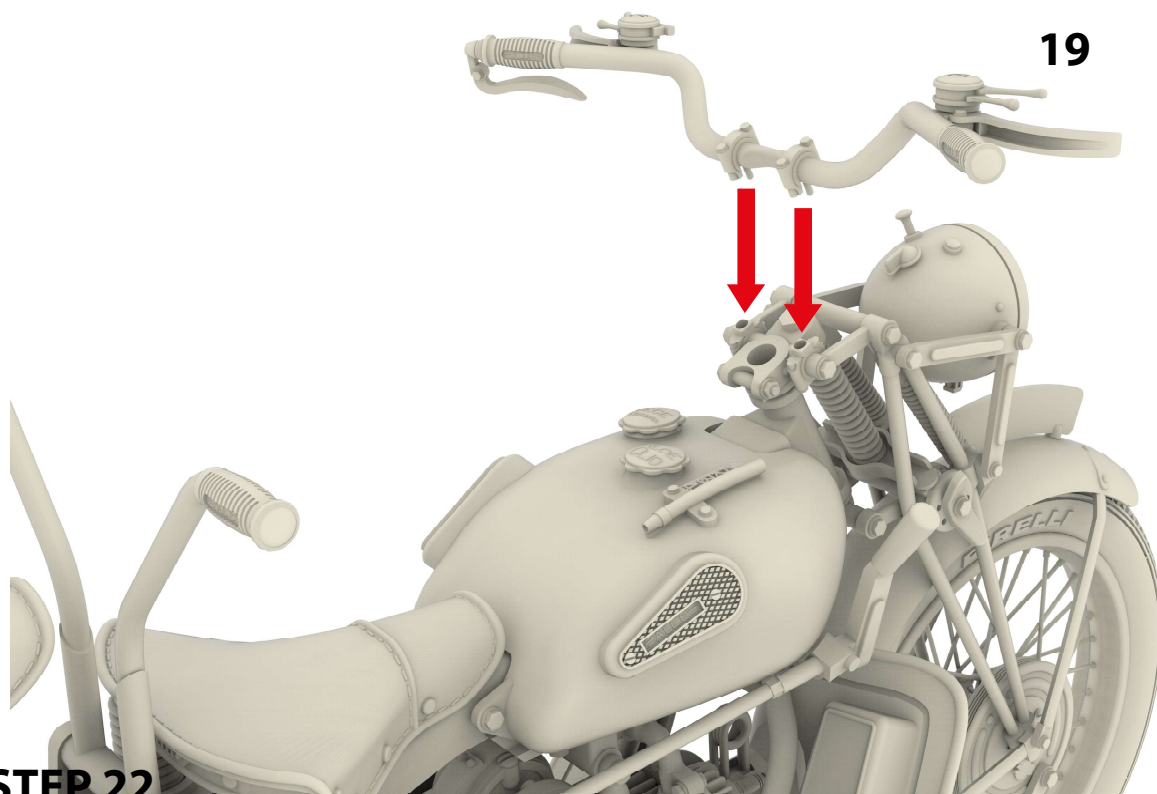

STEP 22

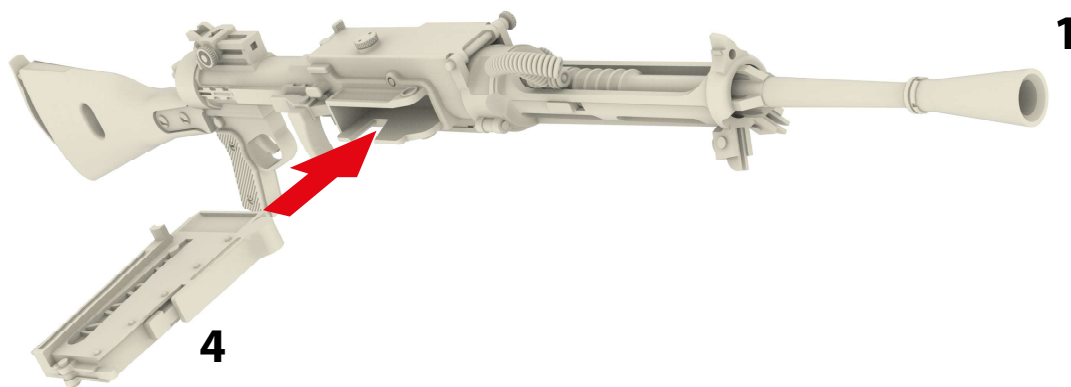

STEP 23

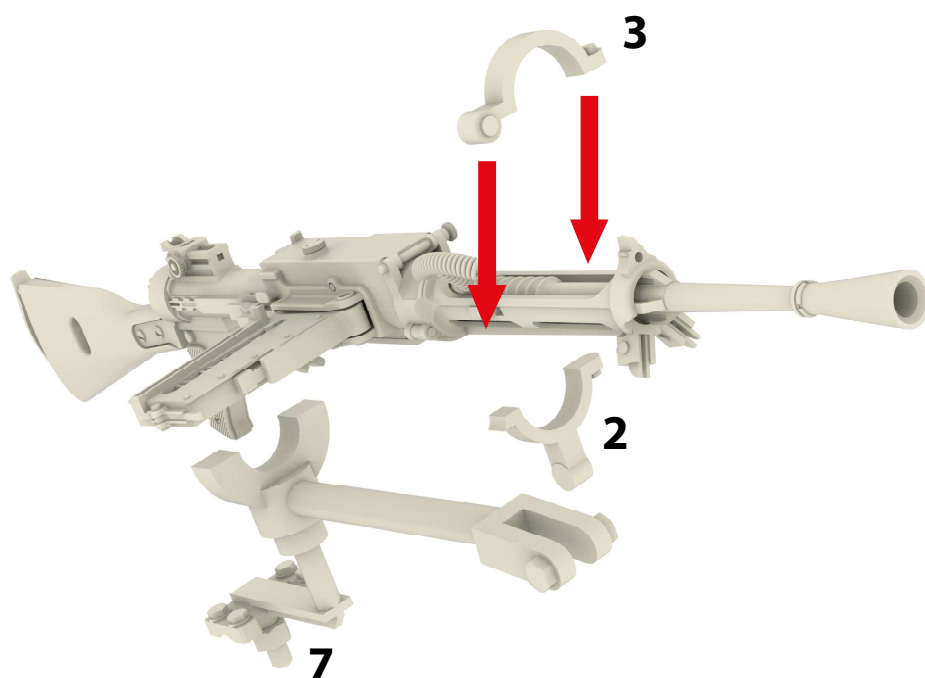

STEP 24

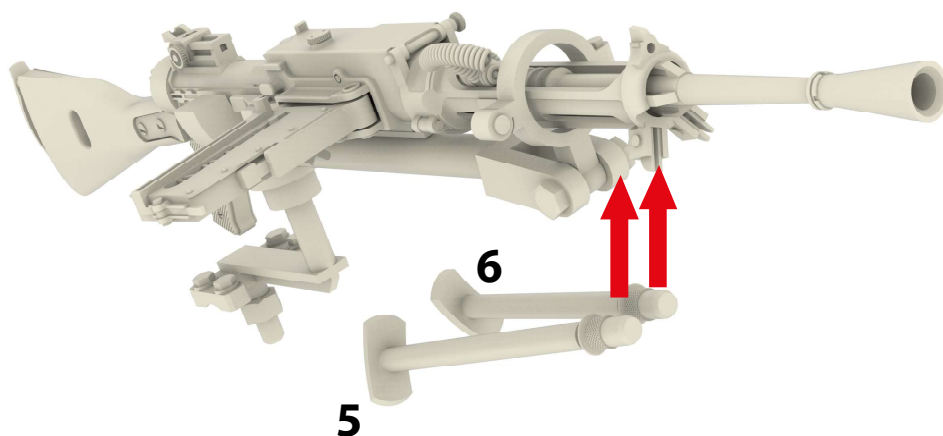

STEP 25

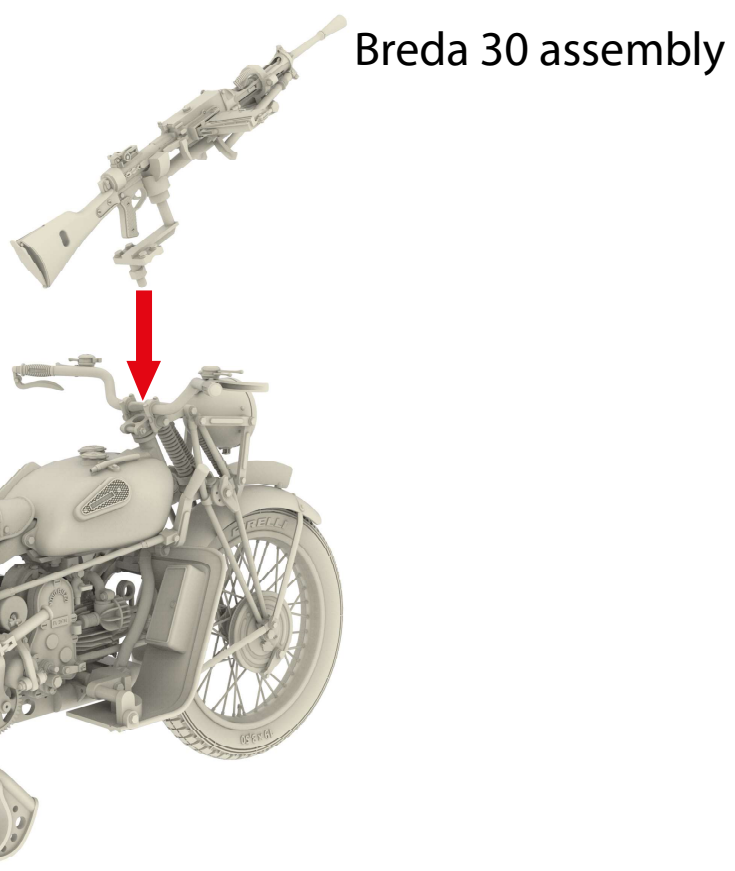

STEP 26

Kit Assembly
HDM35120

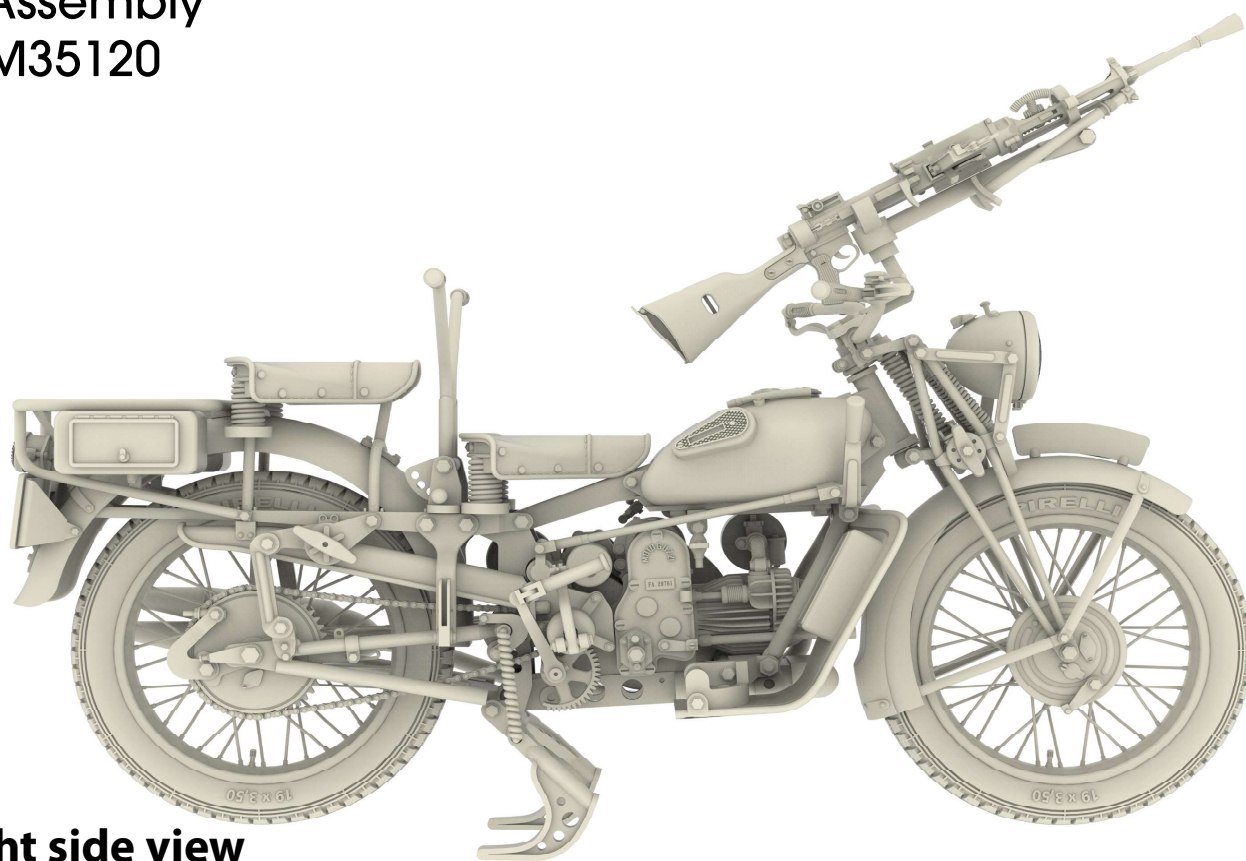

Right side view

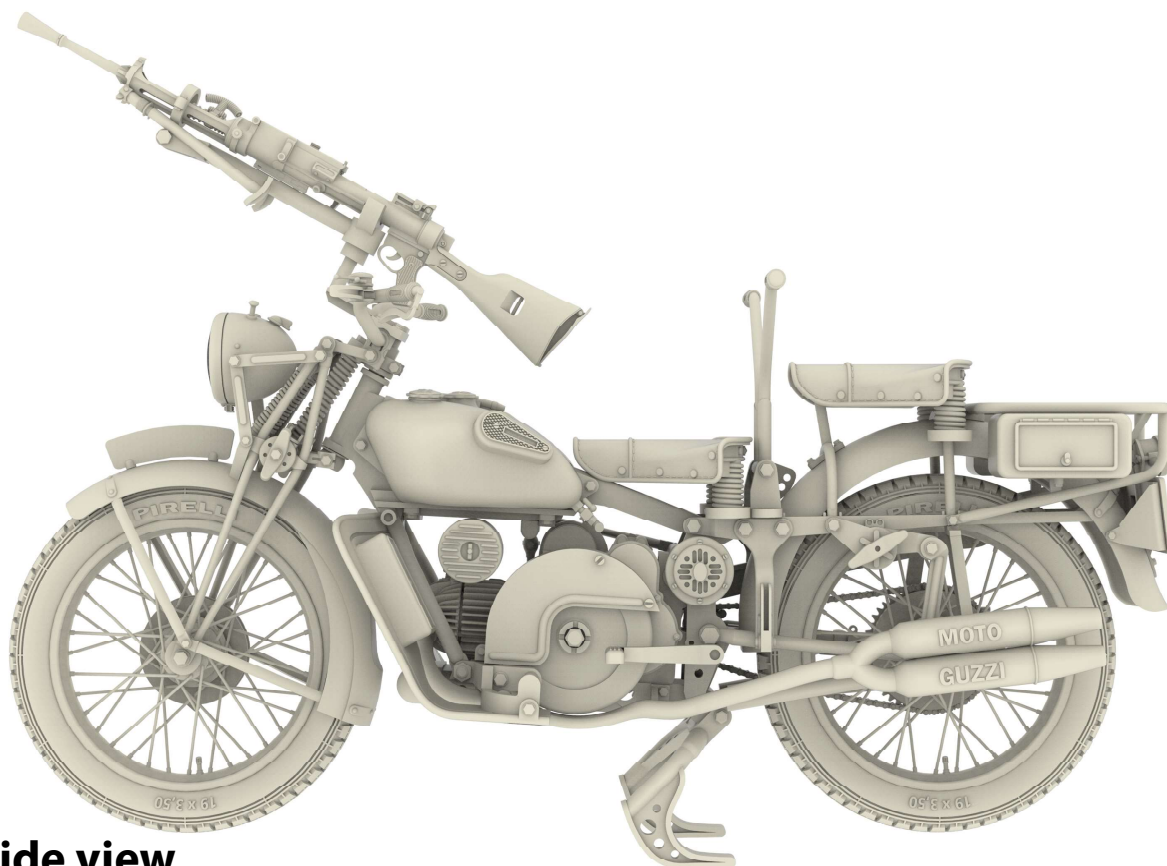

Left side view

Positioning of decals

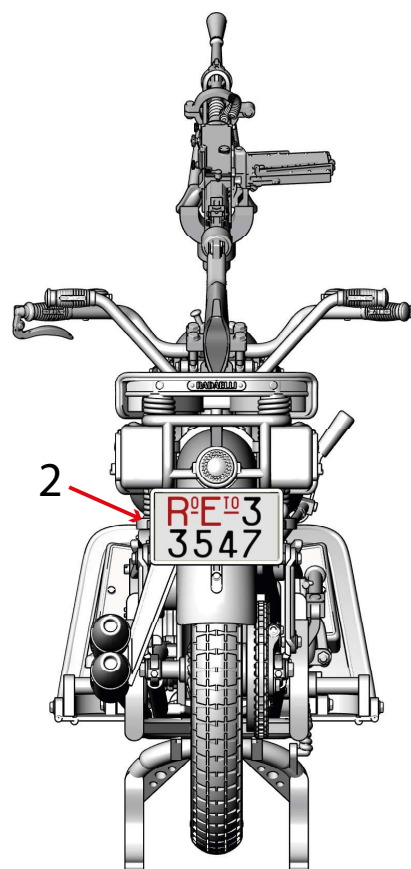
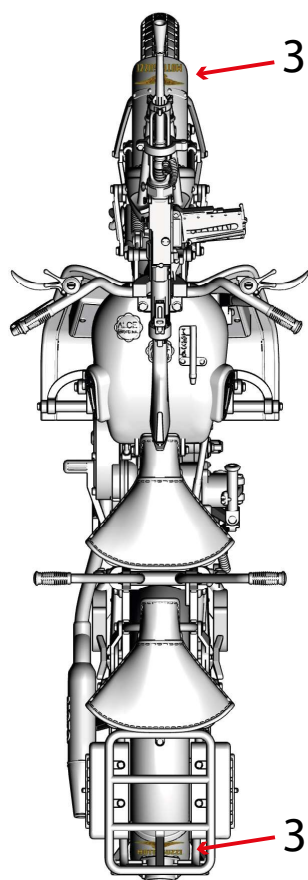
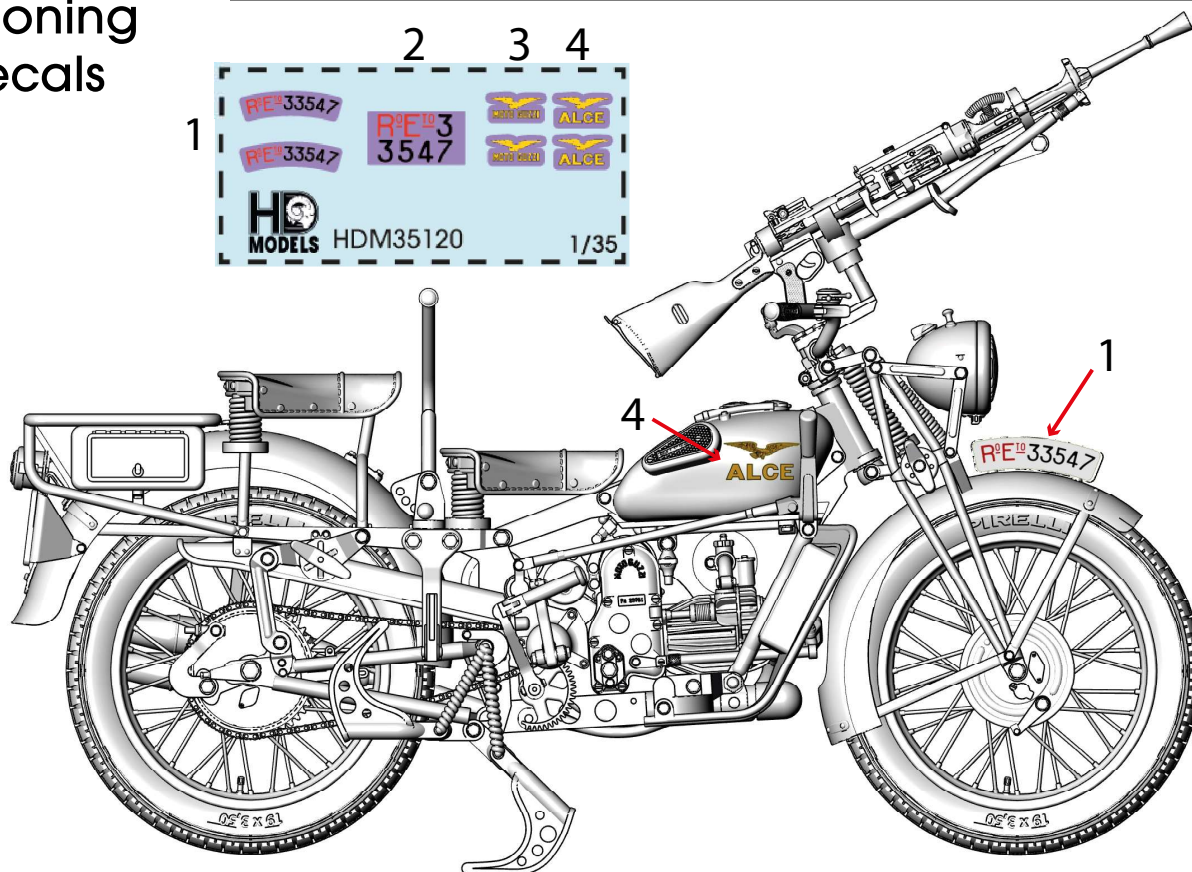
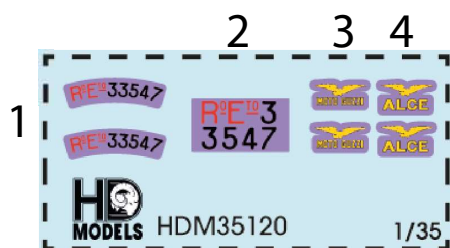

Reference images

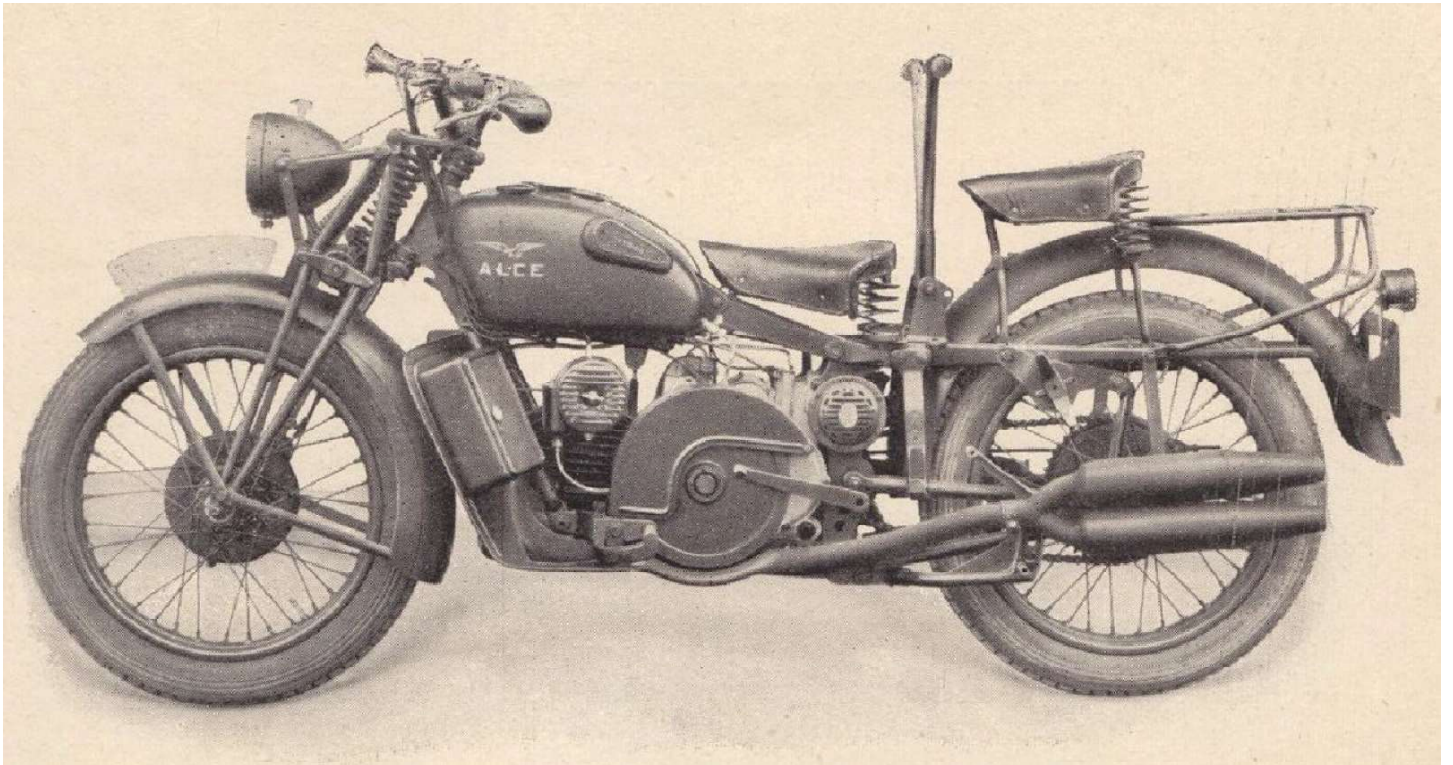
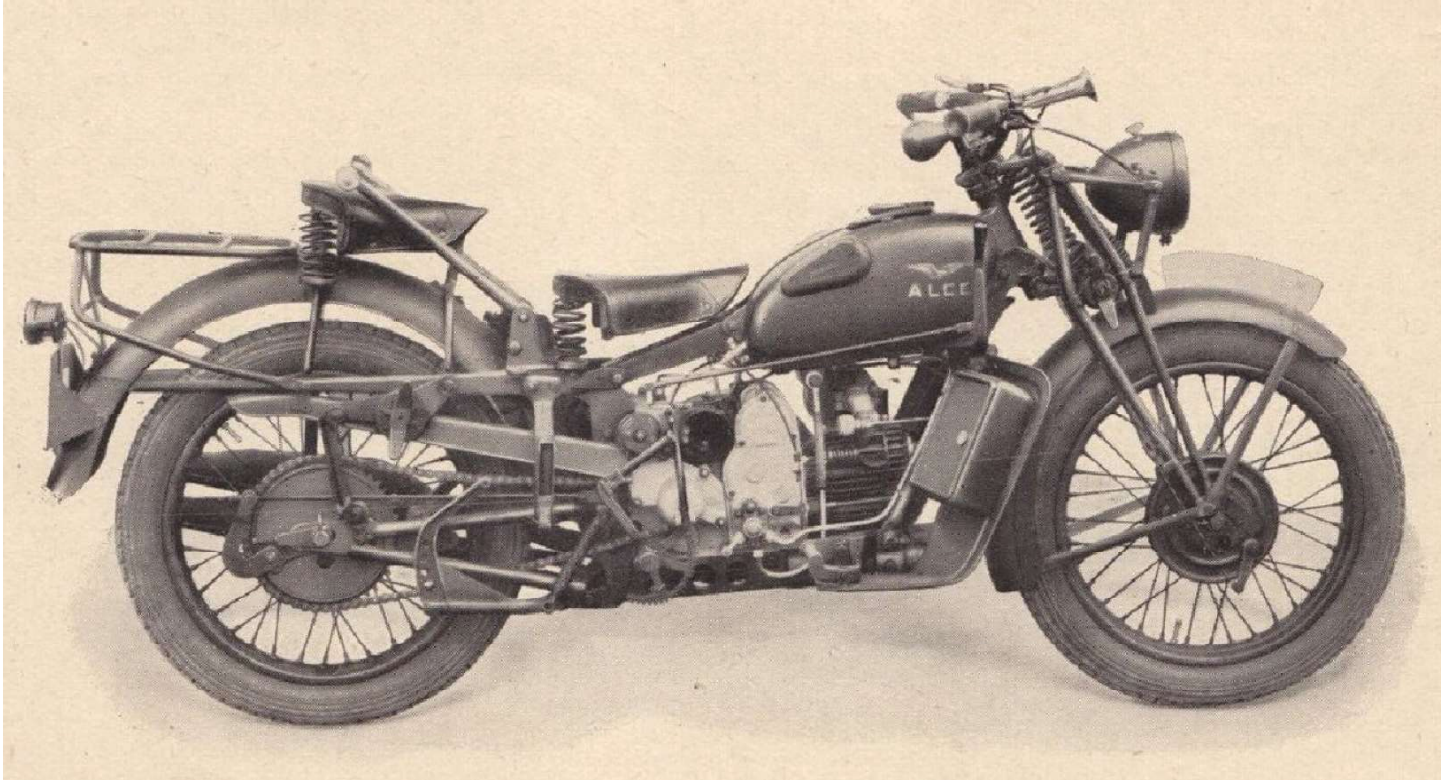

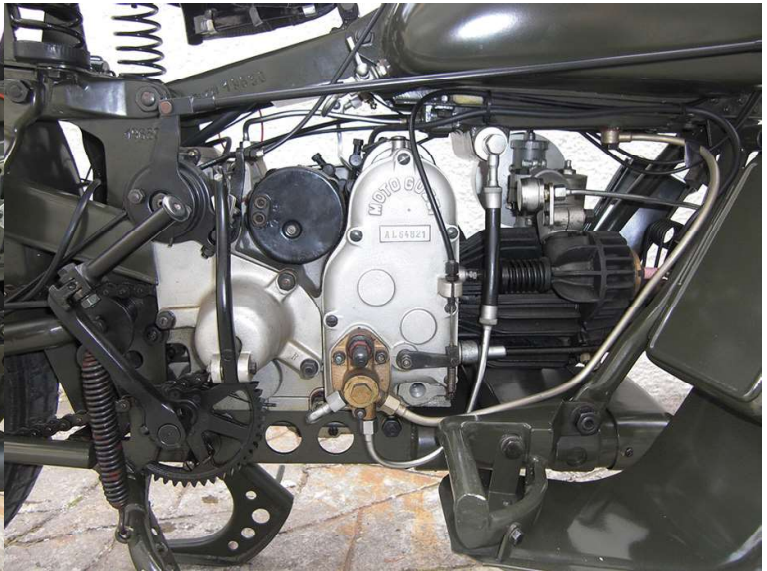

HDM35120

Boxart HD Models
3D project by F. De Petrillo
Figure painted by G. Montesano
Figure sculpted by R. Cerilli
Base and Guzzi painted by
F.Mosca and F. mercuri



Three heads option



HD MODELS

HDM35120

Boxart HD Models
3D project by F. De Petrillo
Figure painted by G. Montesano
Figure sculpted by R. Cerilli
Base and Guzzi painted by
F.Mosca and F. mercuri



HD MODELS

HDM35120

Boxart HD Models
3D project by F. De Petrillo
Figure painted by G. Montesano
Figure sculpted by R. Cerilli
Base and Guzzi painted by
F.Mosca and F. mercuri

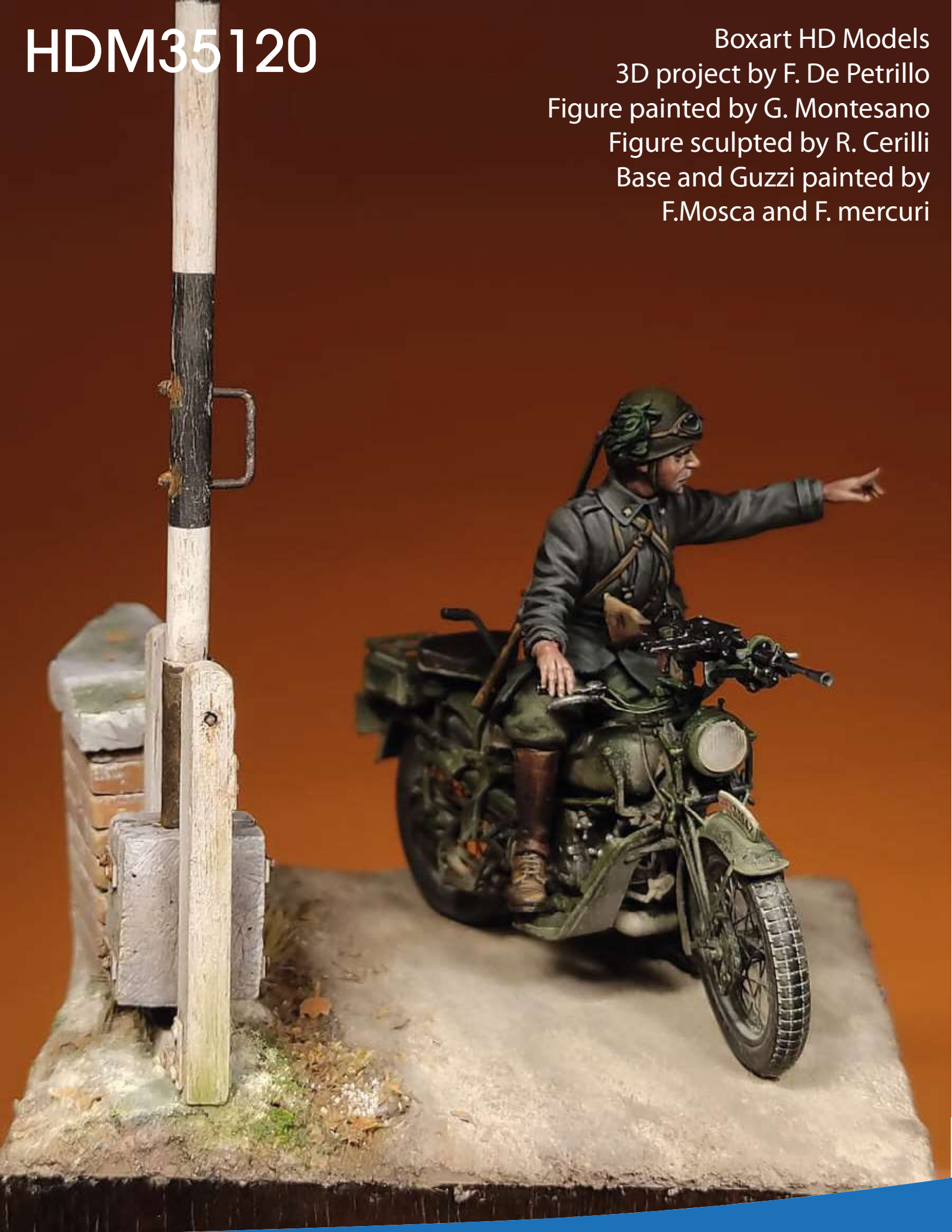

HDM35120

Boxart HD Models
3D project by F. De Petrillo
Figure painted by G. Montesano
Figure sculpted by R. Cerilli
Base and Guzzi painted by
F.Mosca and F. mercuri

